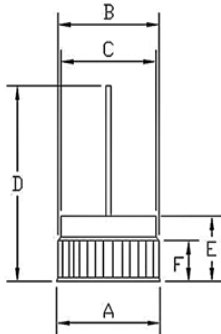

产品外形尺寸:
Product appearance size

$A = \varnothing 13.0 \pm 0.2 \text{mm}$
 $C = \varnothing 11.4 \pm 0.2 \text{mm}$
 $E = 7.90 \pm 0.2 \text{mm}$

$B = \varnothing 12.76 \pm 0.02 \text{mm}$
 $D = 25.0 \text{mm}$
 $F = 4.15 \pm 0.20 \text{mm}$

Dimension in millimeters

特性曲线图:
RATINGS AND CHARACTERISTIC CURVES

FIG. 1 - 最大正向平均电流降额
 FIG. 1 - MAXIMUM AVERAGE FORWARD CURRENT DERATING

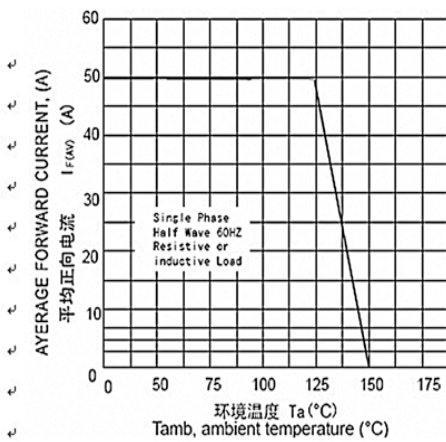

FIG. 2 - 最大非重复正向浪涌电流
 FIG. 2 - MAXIMUM NON-REPETITIVE FORWARD SURGE CURRENT

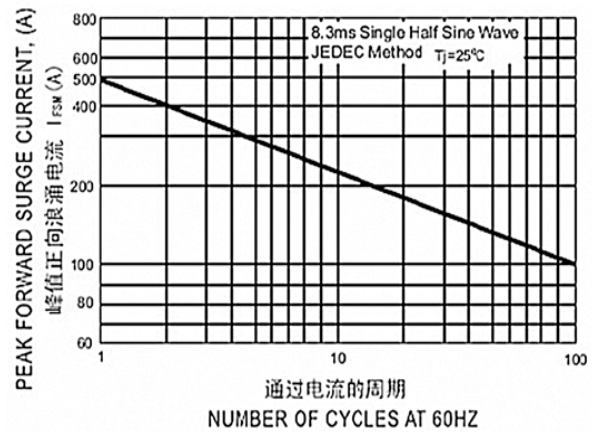

FIG. 3 - 脉冲波形
 FIG. 3 - PULSE WAVEFORM

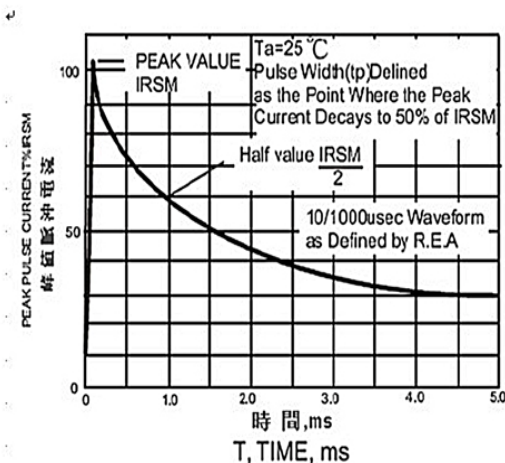

FIG. 4 - 正向特性曲线(典型)
 FIG. 4 - TYPICAL FORWARD CHARACTERISTICS

